

TechConnect World 2010

June 22-23, 2010

Anaheim Convention Center

Anaheim, CA

Hall B

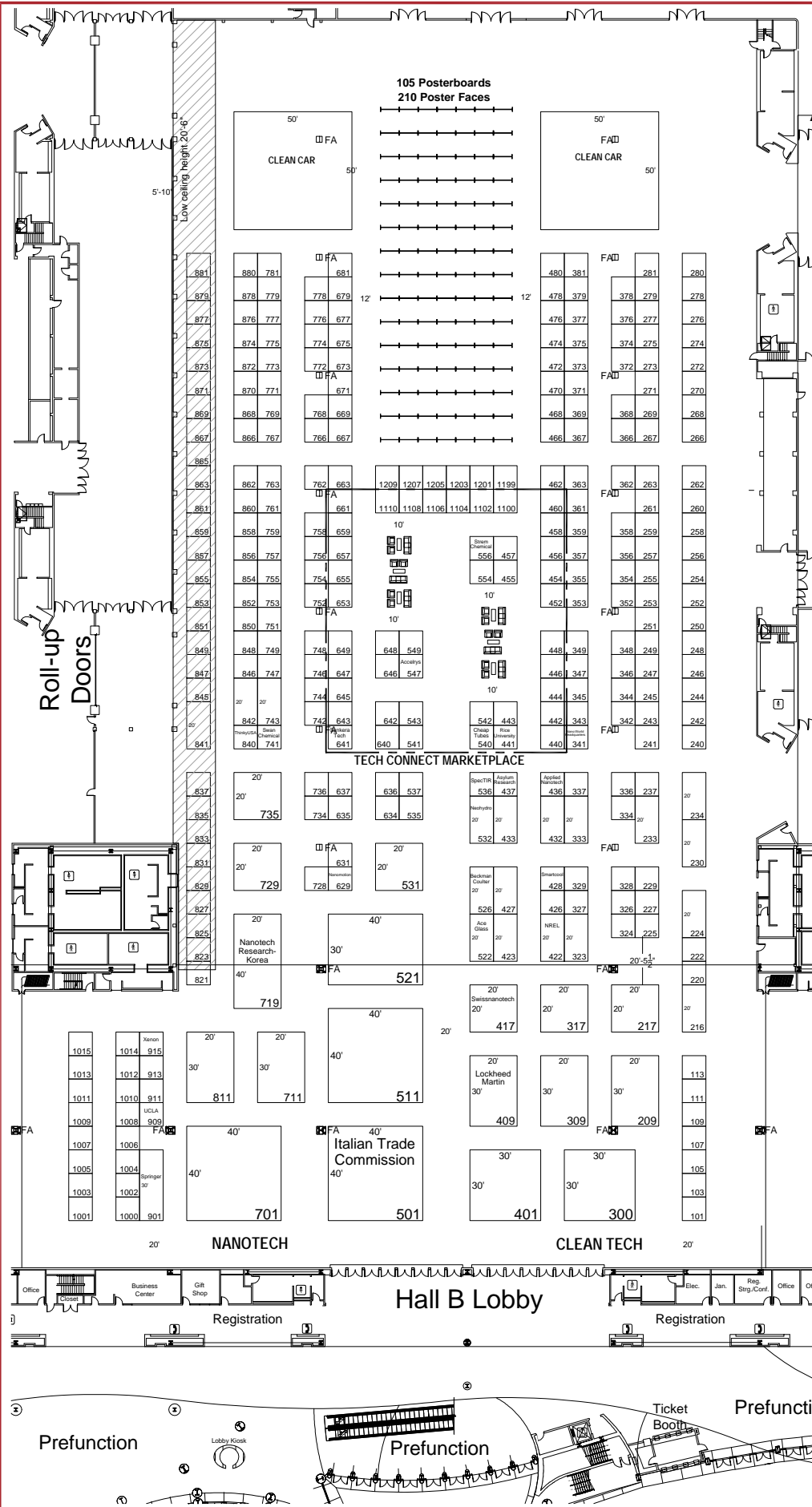

Inventory as of 06/17/2009

6,000 SqFt Rented
39,500 SqFt Available

| Dimension | Size | Qty |
|----------------|-------|------------|
| 10'x10' | 100 | 276 |
| 10'x20' | 200 | 18 |
| 10'x30' | 300 | 1 |
| 20'x20' | 400 | 6 |
| 20'x30' | 600 | 5 |
| 20'x40' | 800 | 1 |
| 30'x30' | 900 | 2 |
| 30'x40' | 1,200 | 1 |
| 40'x40' | 1,600 | 3 |
| Totals: | | 313 |

BUILDING LEGEND

FA - Fire Alarm
(Apparatus on all columns)

SYMBOLS LEGEND

- ELEVATOR
- WOMEN'S ROOM
- MEN'S ROOM
- PUBLIC TELEPHONES
- WATER FOUNTAIN

COLUMNS LEGEND

- COLUMN 2'-11" x 2'-10"
- COLUMN 4'-4" x 3'-3"
- COLUMN 3'-8" x 3'-3"
- COLUMN 3'-8" x 3'-3"
- COLUMN 3'-8" x 3'-10"

CEILING HEIGHT

Pri-Med MAX Height- 20 feet

UTILITIES

Are available from ceilings & columns only.

BOOTHS ARE 10'X10' UNLESS NOTED

BOOTH AISLES ARE 10' UNLESS NOTED

NOTED

NOTED

* = LAST IN FIRST OUT

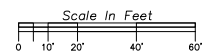

*This floor plan is subject to fire marshal approval.



139 Campanelli Drive
Middleborough, MA 02346
Phone: 508-548-8500
Fax: 508-523-1409

- Account Executive: Pam Mason
- Revision Date: 06.17.09
- Rev. # 13
- Drawn By: Jissel Jerez/MM
- Scale: Fit to page

Disclaimer:
Every effort has been made to ensure the accuracy of all information contained on this floor plan. However, no warranties, either expressed or implied are made with respect to this floor plan. If the location of building columns, utilities or other architectural components of the facility is a consideration in the construction or usage of an exhibit, it is the sole responsibility of the exhibitor to physically inspect the facility to verify all dimensions and locations.